

**Part No. B-41174 Rear Wheel Support Stand and
Part No. B-41174-2 Replacement Pad**

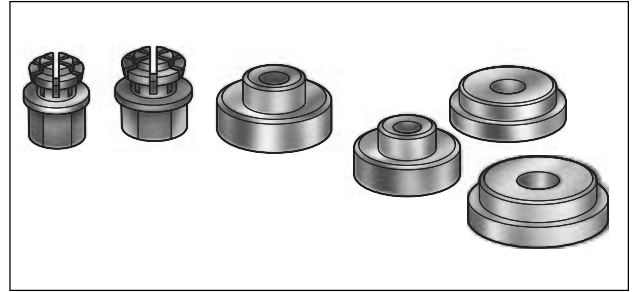

Part No. B-43993-7/-8 Wheel Bearing Collets

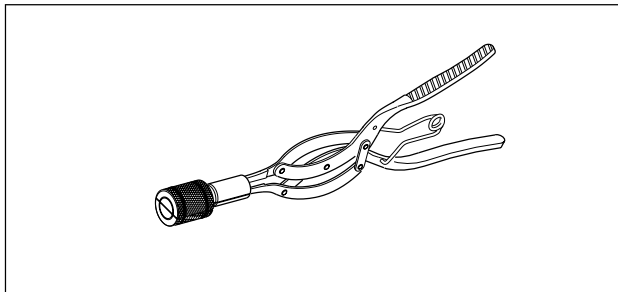

Part No. B-42887 Brake Caliper Piston Remover

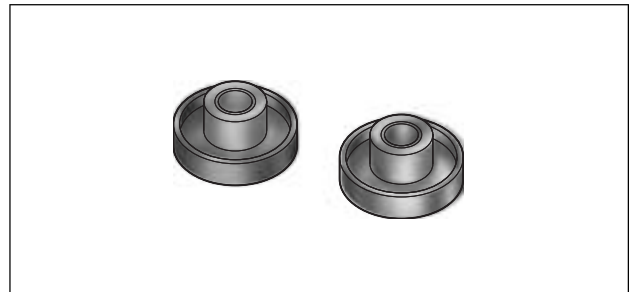

**Part No. B-45521 Steering Head Bearing Remover/
Installer**

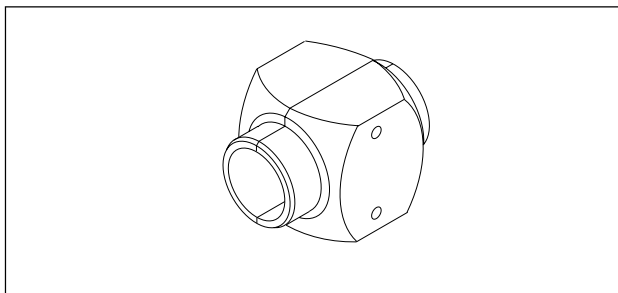

Part No. B-43721 Front Fork Seal Driver

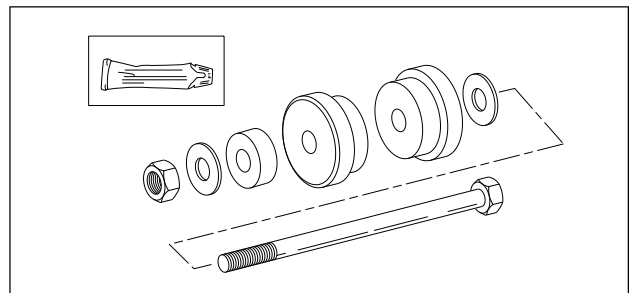

**Part No. HD-39302 Steering Head Bearing Race Installer
(Used with B-45521)**

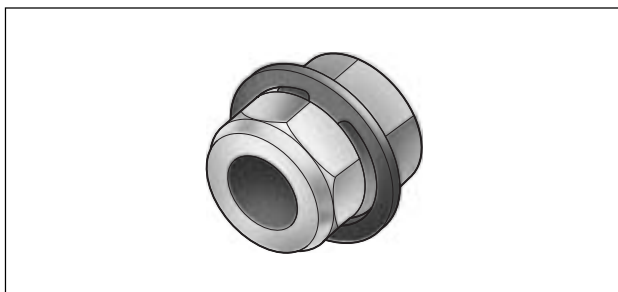

Part No. B-46279 7/8" Axle Wrench (Hex)

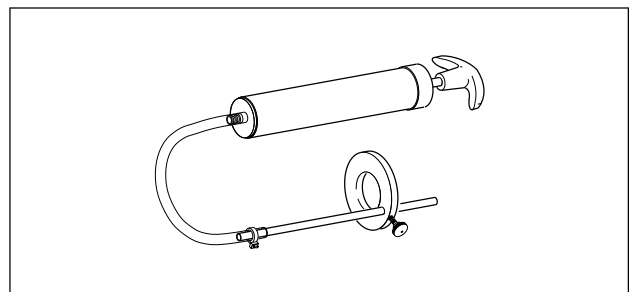

Part No. B-59000B Pro Level Oil Gauge

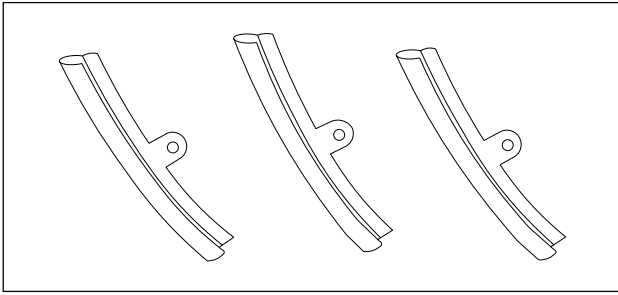

Part No. HD-01289 Rim Protectors

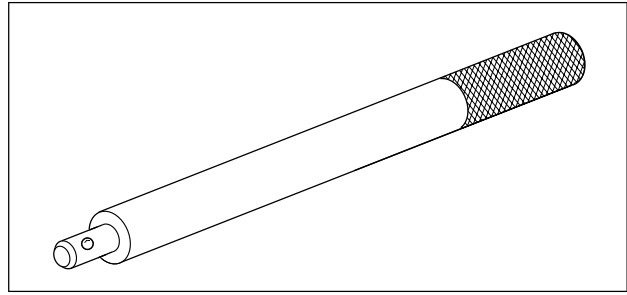

Part No. HD-33416 Universal Driver Handle

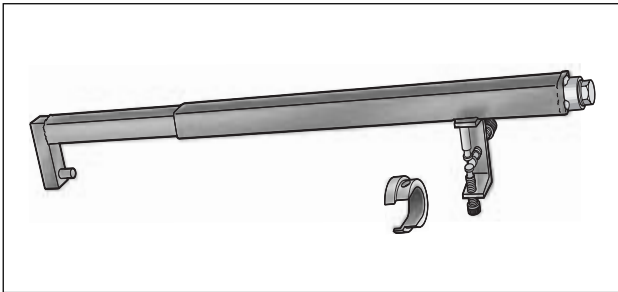

Part No. HD-45966 Fork Spring Compressing Tool

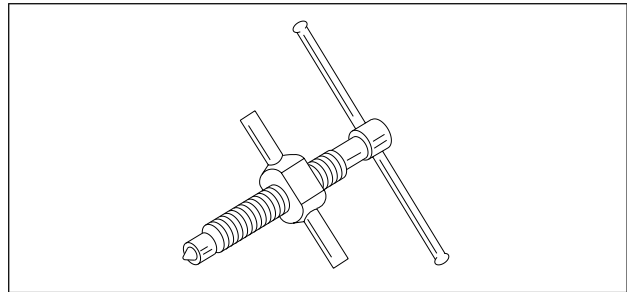

Part No. HD-33418 Universal Puller Forcing Screw

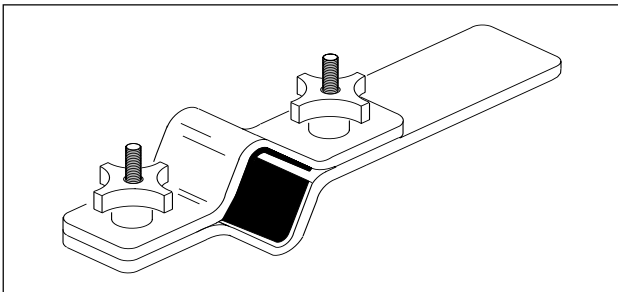

Part No. HD-41177 Fork Tube Holder

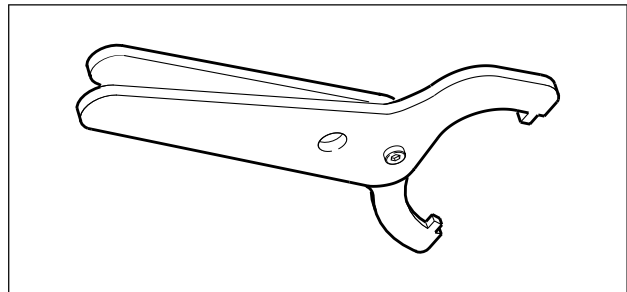

Part No. HD-94700-52C Shock Spanner Preload Adjustment Tool

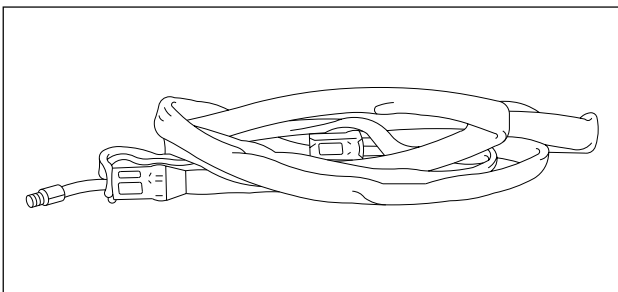

Part No. HD-28700 Tire Bead Expander

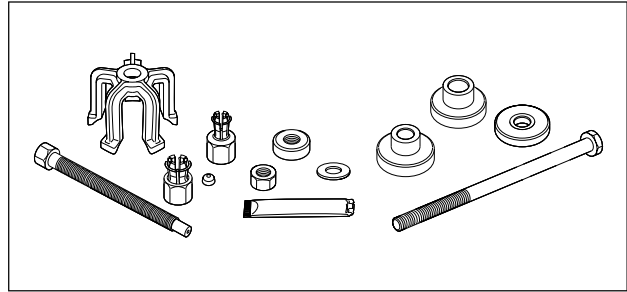

Part No. HD-44060 Wheel Bearing Remover/Installer

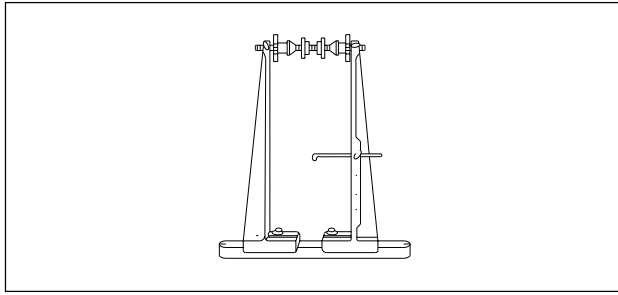

**Part No. HD-99500-80 Wheel Truing
and Balancing Stand**

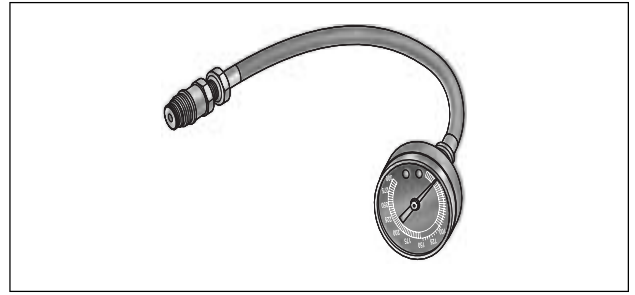

Part No. HD-33223-1 Cylinder Compression Gauge

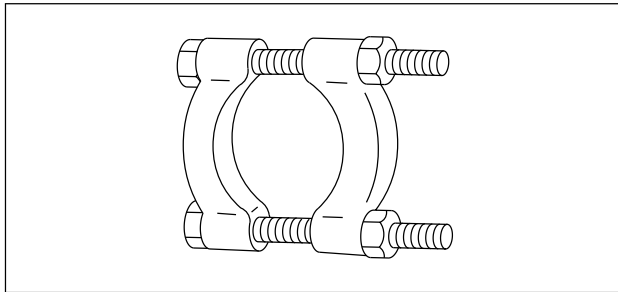

**Part No. HD-95637-46A Wedge Attachment for
Claw Puller. Use with HD-95635-46.**

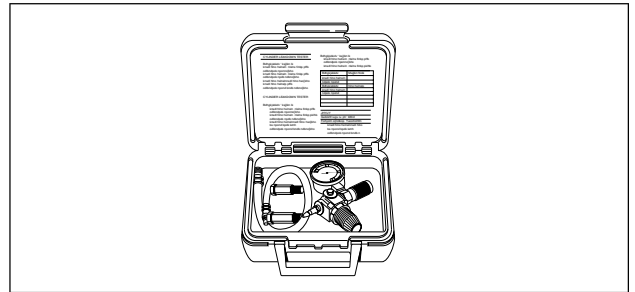

Part No. HD-35667A Cylinder Leakdown Tester

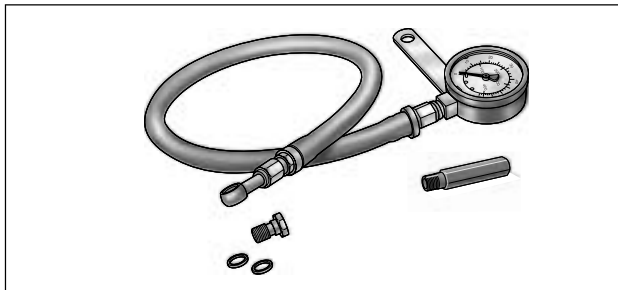

Part No. HD-96921-52A Oil Pressure Gauge

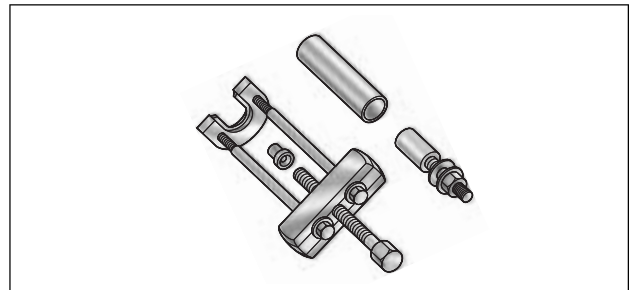

Part No. HD-34902-B Bearing Race Remover/Installer

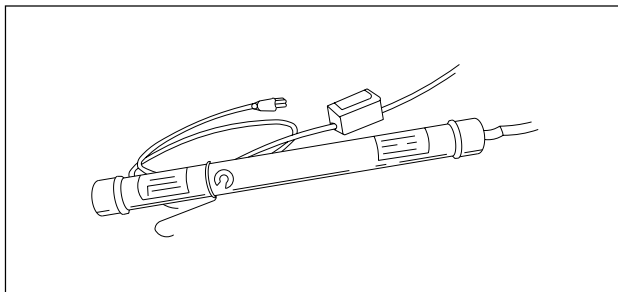

Part No. HD-35457 Black Light Leak Detector

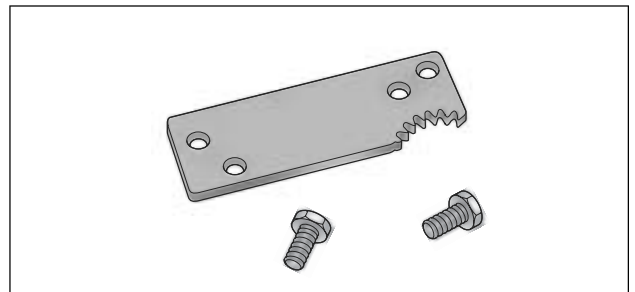

Part No. HD-43984 Crankshaft Locking Tool

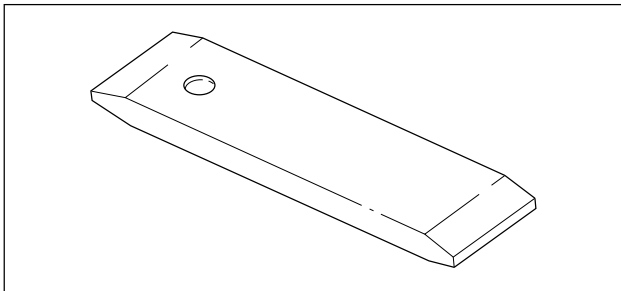

Part No. HD-38362 Sprocket Locking Link (XB9SX)
Part No. HD-46283 Sprocket Locking Link
(1200 models)

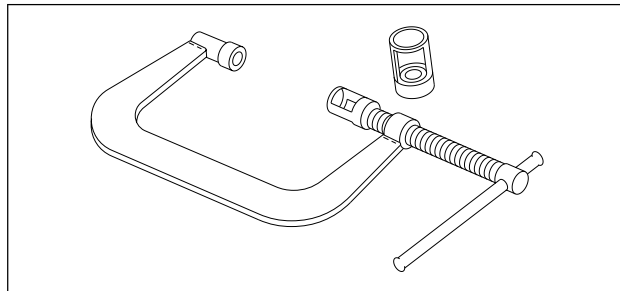

Part No. HD-34736B Valve Spring Compressor

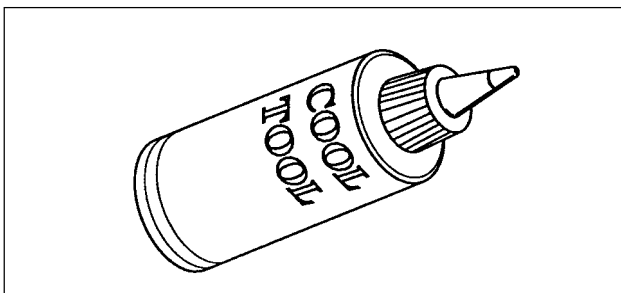

Part No. HD-39964 Reamer Lubricant (Cool Tool)

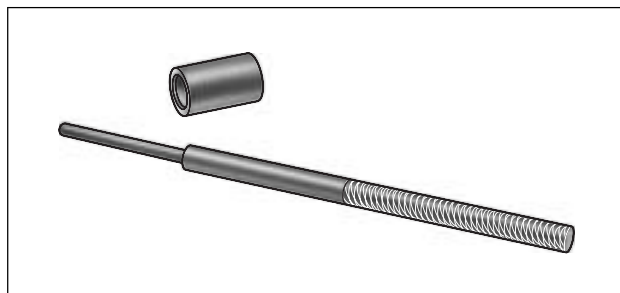

Part No. B-45524 Valve Guide Installer

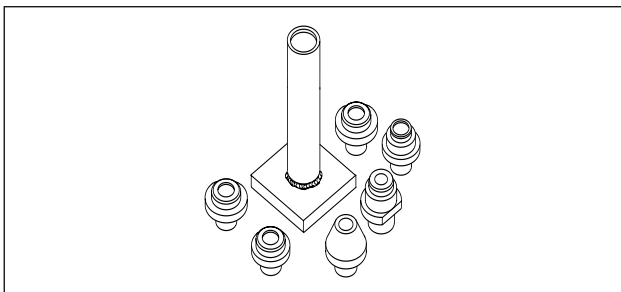

Part No. HD-39782 Cylinder Head Support

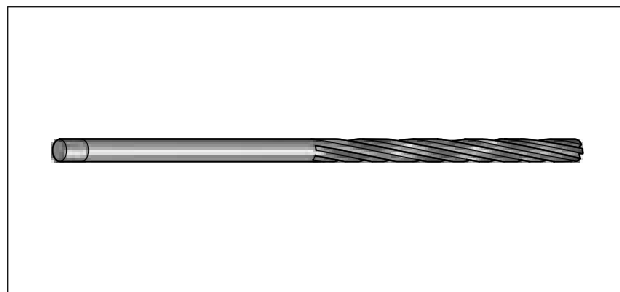

Part No. B-45523 Valve Guide Reamer (7mm)

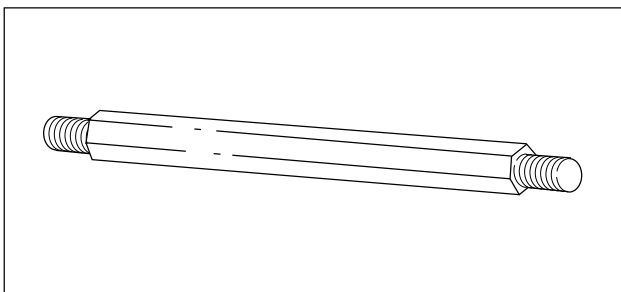

Part No. HD-39786 Cylinder Head Holding Fixture

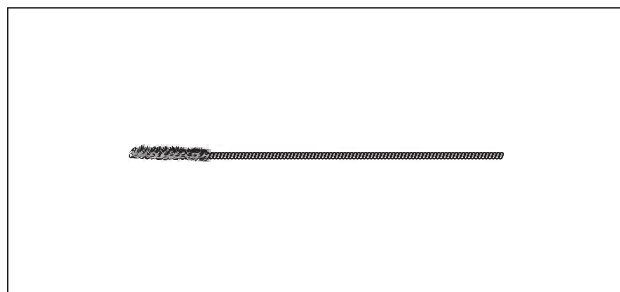

Part No. B-45525 Valve Guide Hone

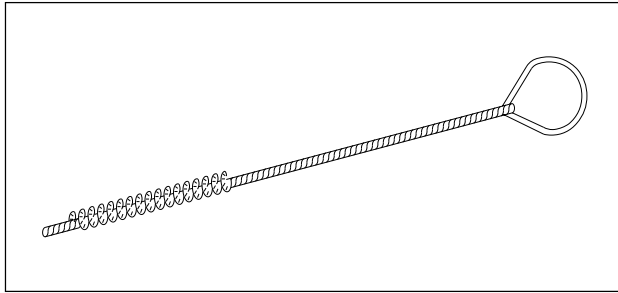

Part No. HD-34751 Nylon Valve Guide Brush

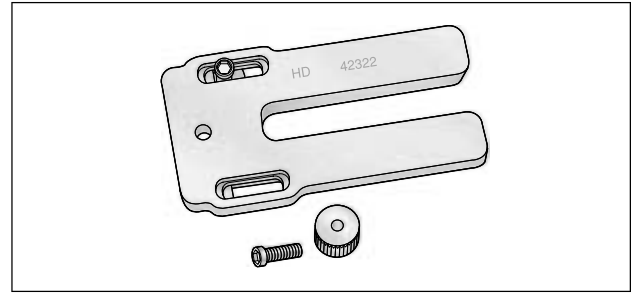

Part No. HD-42322 Piston Support Plate

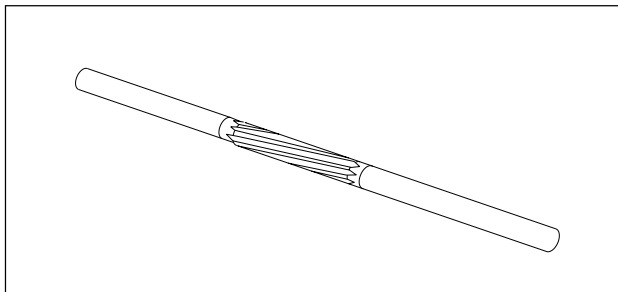

Part No. HD-94804-57 Rocker Arm Bushing Reamer

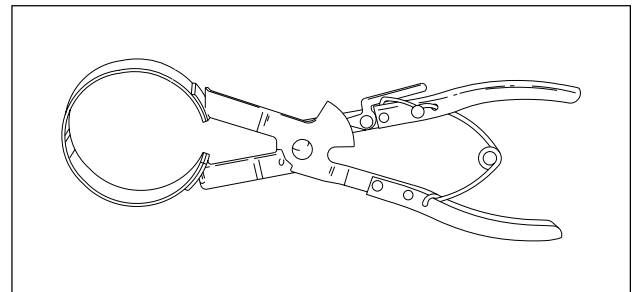

Part No. HD-96333-51C Piston Ring Compressor

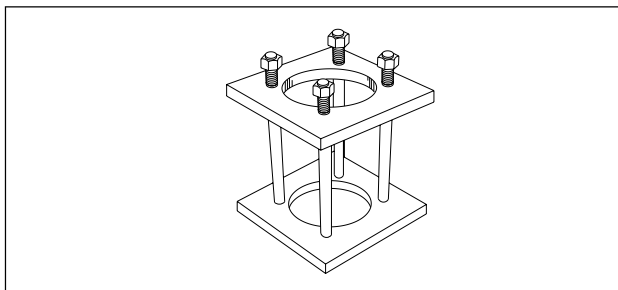

**Part No. HD-33446A Cylinder Torque Plates
and Torque Plate Bolts Part No. HD-33446-86**

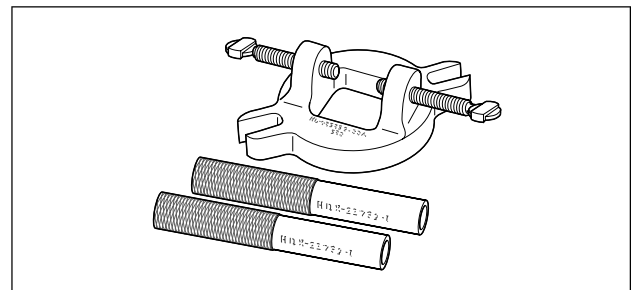

**Part No. HD-95952-33B Connecting Rod
Clamping Tool**

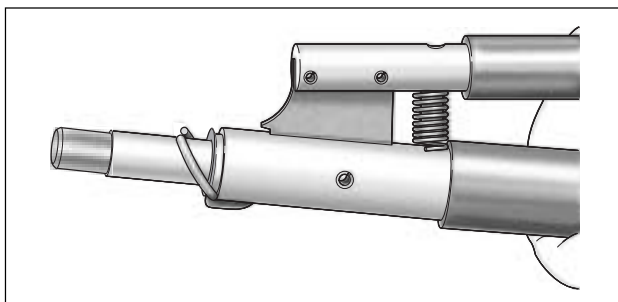

**Part No. HD-34623C Piston Pin
Retaining Ring Installer/Remover**

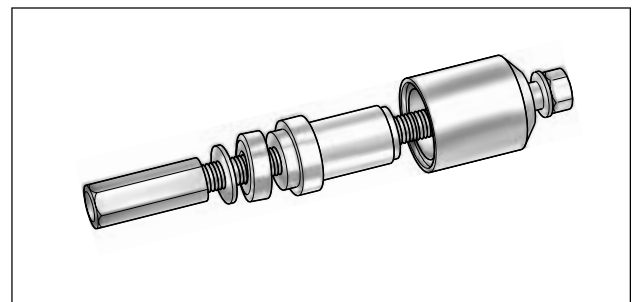

Part No. HD-95970-32D Piston Pin Bushing Tool

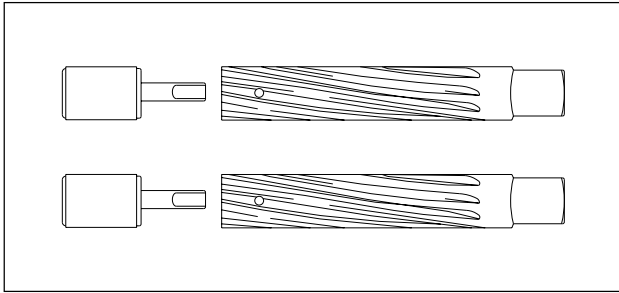

Part No. HD-94800-26A Connecting Rod Bushing Reamers and Pilots

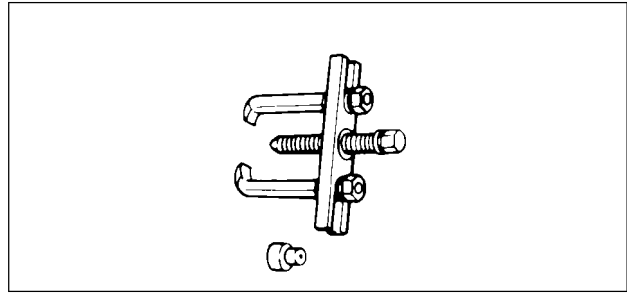

Part No. HD-97292-61 Two Claw Puller

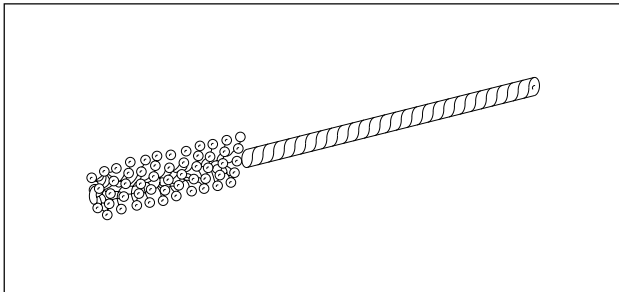

Part No. HD-35102 Wrist Pin Bushing Hone (20 mm)

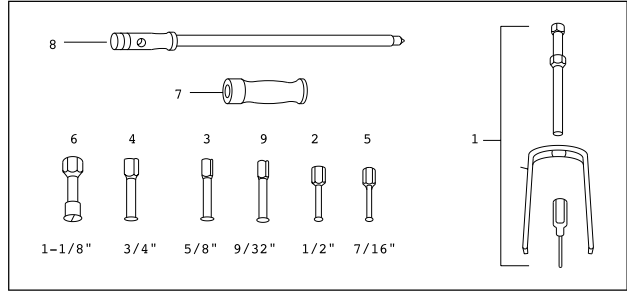

Part No. HD-95760-69A Bushing/Bearing Puller Tool Set.
Set includes items 1-7. Items 8 (HD-95769-69), 9 (HD-95770-69) and 10 (HD-95771-69) are optional.

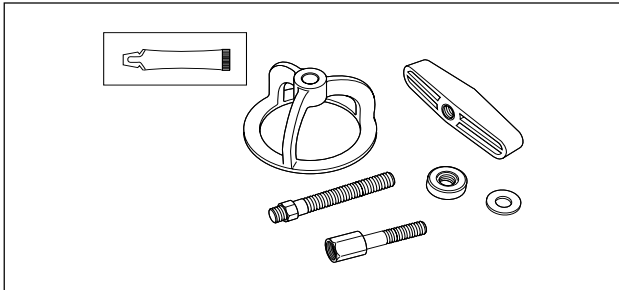

Part No. HD-38515-A Clutch Spring Compressing Tool and Part No. HD-38515-91 Forcing Screw

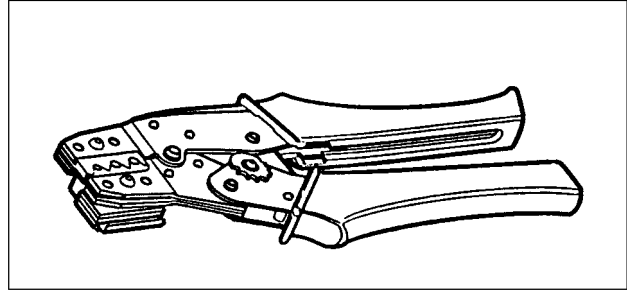

Part No. HD-39965 Deutsch Terminal Crimp Tool

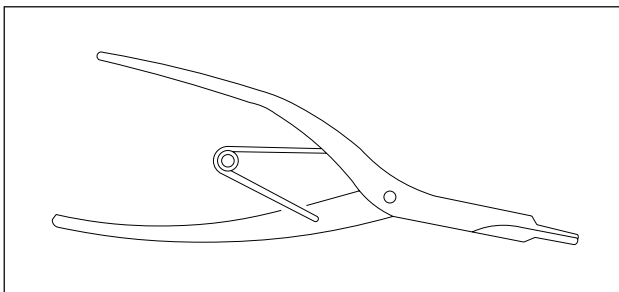

Part No. J-5586 Transmission Shaft Retaining Ring Pliers



Part No. HD-41354 Speedometer Tester

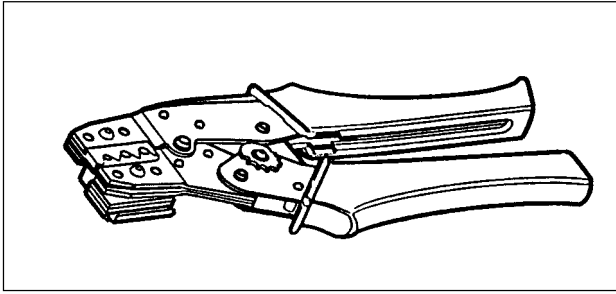

Part No. HD-41609 Amp Terminal Crimp Tool

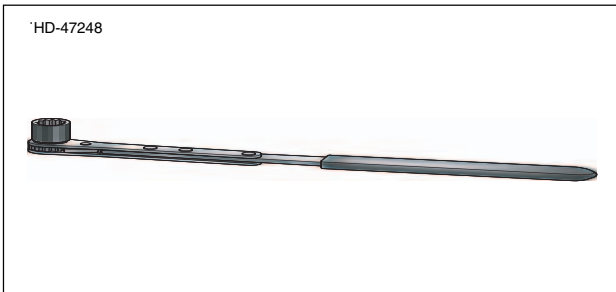

Part No. HD-47248 Rocker Housing Wrench

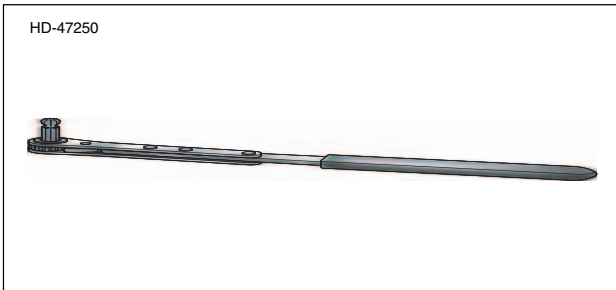

Part No. HD-47250 Intake Manifold Wrench

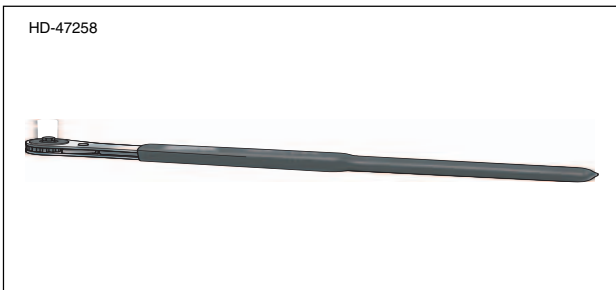

Part No. HD-47258 Rocker Cover Wrench

NOTES
